

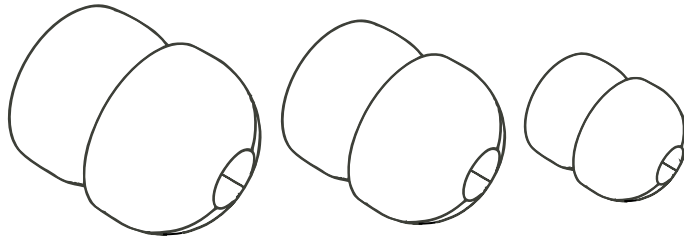

SPL2

dB Logic uses SPL2 -- short for Sound Pressure Level Limiting -- to keep the volume below dangerous levels. SPL2 does not require any adjustments, batteries, or programming -- it works automatically and is always on. SPL2 Keeps the maximum sound pressure at a level high enough to capture the full feeling of great music while also helping to ensure a lifetime of listening by reducing the chance of noise induced hearing loss.



Large

Medium

Small

Select the proper size eartips

Three different sizes of eartip are included, in pairs. Select the size that provides a snug, sealed fit to your ear. If the eartips are too loose, the sound quality will not be as good.

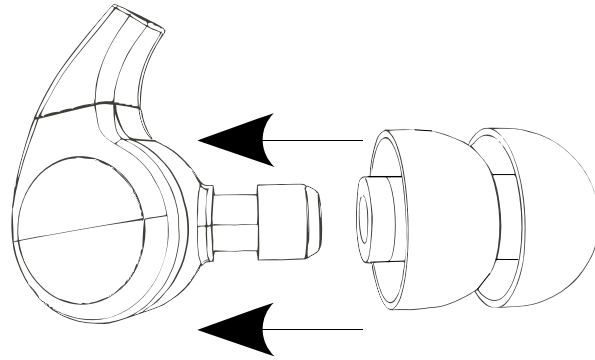

Attach eartips fully

Each eartip must be fully installed on the earpiece. Push each tip on until it is securely captured by the stem of the earpiece.



Straight down

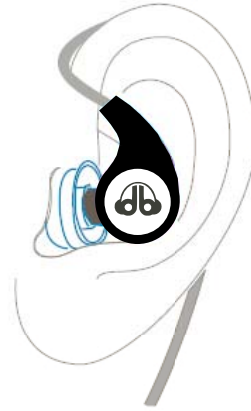

Behind-the-ear

Insert in ears

Earpieces can be worn with cable behind the ear or with cable straight down. Behind the ear style is recommended for active use and optimum comfort.

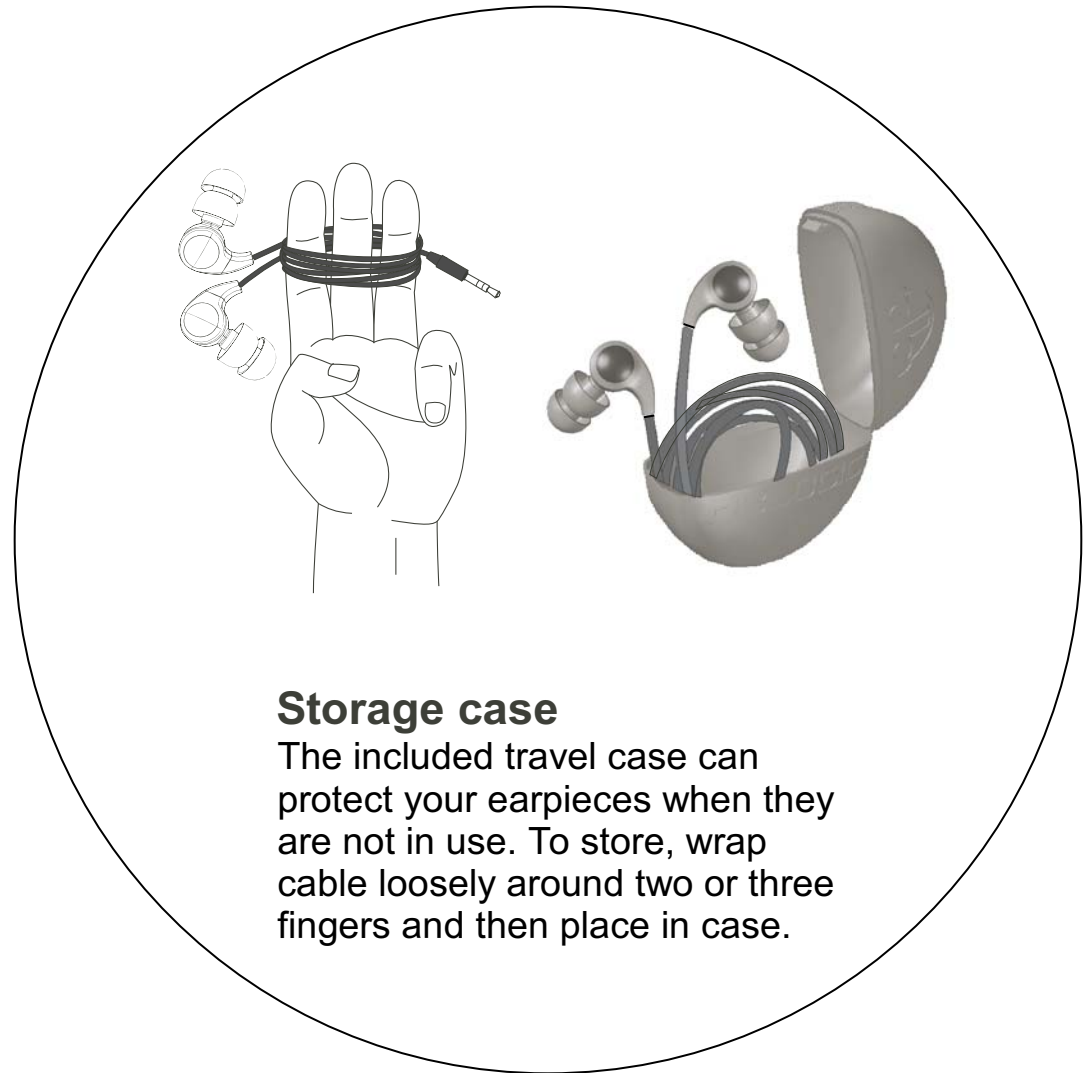

Storage case

The included travel case can protect your earpieces when they are not in use. To store, wrap cable loosely around two or three fingers and then place in case.



Stop listening if you experience ringing in your ears or ear fatigue.

Not for use under water.

Not intended as SPL protection for shooting or other ambient noises.

To register your product please visit our
website at:

www.dblogic.com/register

Disposal of Waste Equipment by Users in Private Households in the European Union



This symbol means do not dispose of your product with your other household waste. Instead, you should protect human health and the environment by handing over your waste equipment to a designated collection point for the recycling of waste electrical and electronic equipment. For more information, please contact your household waste disposal service.

WARRANTY

dB Logic, LLC (dBL) warrants this hardware product against defects in materials and workmanship under normal use for a period of ONE (1) YEAR from the date of retail purchase by the original end-user purchaser (“Warranty Period”). If a hardware defect arises and a valid claim is received by dBL within the Warranty Period, at its option and to the extent permitted by law, dBL will either (1) repair the product at no charge, using new parts or refurbished parts that are equivalent to new in performance and reliability, (2) exchange the product with a product that is new or refurbished and is equivalent to new in performance and reliability and is at least functionally equivalent to the original product, or (3) refund the original purchase price of the product.

EXCLUSIONS AND LIMITATIONS. TO THE EXTENT PERMITTED BY LAW, THIS WARRANTY AND THE REMEDIES SET FORTH ABOVE ARE EXCLUSIVE AND IN LIEU OF ALL OTHER WARRANTIES, REMEDIES AND

(continued)

WARRANTY
(continued)

CONDITIONS, WHETHER ORAL, WRITTEN, STATUTORY, EXPRESS OR IMPLIED. AS PERMITTED BY APPLICABLE LAW, dBL SPECIFICALLY DISCLAIMS ANY AND ALL STATUTORY OR IMPLIED WARRANTIES, INCLUDING, WITHOUT LIMITATION, WARRANTIES OF MERCHANTABILITY AND FITNESS FOR A PARTICULAR PURPOSE AND WARRANTIES AGAINST HIDDEN OR LATENT DEFECTS. IF dBL CANNOT LAWFULLY DISCLAIM STATUTORY OR IMPLIED WARRANTIES THEN TO THE EXTENT PERMITTED BY LAW, ALL SUCH WARRANTIES SHALL BE LIMITED IN DURATION TO THE DURATION OF THIS WARRANTY AND TO THE REPAIR OR REPLACEMENT SERVICE AS DETERMINED BY dBL IN ITS SOLE DISCRETION. SOME STATES (COUNTRIES AND PROVINCES) DO NOT ALLOW THE EXCLUSION OR LIMITATION OF INCIDENTAL OR CONSEQUENTIAL DAMAGES, SO THE ABOVE LIMITATION OR EXCLUSION MAY NOT APPLY TO YOU.